

“Stay Connected” with



HEYware Products

a PennEngineering® Company



## HEYClip™ Shock Proof Snap Rivets

WILL FIT THESE PANELS ASSEMBLED PANEL THICKNESS						PART NO.				DESCRIPTION	PART DIMENSIONS						EXTRACTION FORCE (N)	STYLE
MOUNTING HOLE DIA.		Min.		Max.		Black	Natural	White	Black V-0		A Length		B Head Height		C Head Diameter			
in.	mm.	in.	mm.	in.	mm.						in.	mm.	in.	mm.	in.	mm.		
.083	2,1	.051	1,3	.079	2,0	11870	11871	11872	11870F	SPPR 083-051	.13	3,2	.05	1,2	.17	4,2	39	2
.106	2,7	.134	3,4	.169	4,3	11873	11874	11875	11873F	SPPR 106-133	.22	5,5	.06	1,4	.20	5,0		
.122	3,1	.039	1,0	.079	2,0	11876	11877	11878	11876F	SPPR 122-039	.14	3,5	.07	1,7	.25	6,4	78	2
		.079	2,0	.118	3,0	11879	11880	11881	11879F	SPPR 122-079	.18	4,5						
		.118	3,0	.157	4,0	11882	11883	11884	11882F	SPPR 122-118	.22	5,5						
		.157	4,0	.197	5,0	11885	11886	11887	11885F	SPPR 122-157	.26	6,5						
		.197	5,0	.236	6,0	11888	11889	11890	11888F	SPPR 122-197	.30	7,5						
		.217	5,5	.256	6,5	11891	11892	11893	11891F	SPPR 122-217	.31	8,0						
		.256	6,5	.295	7,5	11894	11895	11896	11894F	SPPR 122-256	.35	9,0						
		.295	7,5	.335	8,5	11897	11898	11899	11897F	SPPR 122-295	.39	10,0						
.142	3,6	.146	3,7	.181	4,6	11900	11901	11902	11900F	SPPR 142-146	.24	6,0	.07	1,8	.31	8,0	196	1
		.177	4,5	.217	5,5	11903	11904	11905	11903F	SPPR 142-177	.31	8,0						
.161	4,1	.067	1,7	.098	2,5	11906	11907	11908	11906F	SPPR 161-067	.16	4,0	.09	2,2	.35	9,0	245	1
		.177	4,5	.217	5,5	11909	11910	11911	11909F	SPPR 161-177	.28	7,0						
		.217	5,5	.256	6,5	11912	11913	11914	11912F	SPPR 161-217	.31	8,0						
		.256	6,5	.295	7,5	11915	11916	11917	11915F	SPPR 161-256	.35	9,0						
		.295	7,5	.335	8,5	11918	11919	11920	11918F	SPPR 161-295	.39	10,0						
		.354	9,0	.413	10,5	11921	11922	11923	11921F	SPPR 161-354	.47	12,0						
.201	5,1	.059	1,5	.098	2,5	11927	11928	11929	11927F	SPPR 201-059	.18	4,5	.11	2,7	.47	12,0	294	1
		.098	2,5	.138	3,5	11930	11931	11932	11930F	SPPR 201-098	.22	5,5						
		.138	3,5	.177	4,5	11933	11934	11935	11933F	SPPR 201-138	.26	6,5						
		.177	4,5	.217	5,5	11936	11937	11938	11936F	SPPR 201-177	.30	7,5						
		.217	5,5	.256	6,5	11939	11940	11941	11939F	SPPR 201-217	.33	8,5						
		.256	6,5	.295	7,5	11942	11943	11944	11942F	SPPR 201-256	.37	9,5						
.295	7,5	.335	8,5	11945	11946	11947	11945F	SPPR 201-295	.41	10,5								
.232	5,9	.118	3,0	.177	4,5	11948	11949	11950	11948F	SPPR 232-118	.25	6,3	.12	3,0	294	1		
.240	6,1	.098	2,5	.157	4,0	11951	11952	11953	11951F	SPPR 240-098	.24	6,0						
		.138	3,5	.217	5,5	11954	11955	11956	11954F	SPPR 240-138	.31	8,0						

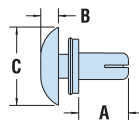

- Designed for fast and easy installation with no tools – just fingertip pressure required.
- Simply place rivet into the hole and press down on the head to fasten; legs expand to securely fasten components.
- Patented design where the Push Pin Head and Rivet Body interlock.
- To release, pull up on rivet head section.
- Round head provides a clean, finished look.
- Part Description Key: SPPR X-Y where X = Mounting Hole Diameter (inches) and Y = minimum Panel Thickness (inches).
- Standard Pack – 1,000/bag.

Material Nylon 6 V-2  
 Flammability Rating 94V-2  
 Temperature Range -22°F (-30°C) to 167°F (75°C)

Nylon 6/6 V-0  
 94V-0  
 -22°F (-30°C) to 185°F (85°C)